

- NOTES:
- LAYOUT IS INDICATIVE ONLY. FINAL POSITION OF SERVICES TO BE CONFIRMED BEFORE COMMENCEMENT OF CONSTRUCTION.
  - CONNECTIONS TO EXISTING 300MM DUCTILE IRON WATER MAINS SHALL BE IN ACCORDANCE WITH IRISH WATER CODE OF PRACTICE FOR WATERMANS.
  - ALL WATER MAIN WORKS TO BE IN ACCORDANCE WITH IRISH WATERS STANDARD DETAILS FOR ALL WATERMAIN PIPE MATERIAL TO BE PE100 SPPR17 HDPE.
  - WHERE 12M COVER CANNOT BE ACHIEVED THE PE100 SHALL BE A MINIMUM OF 1.5M ABOVE FINISHED FLOOR LEVEL AS PER IRISH WATER CODE OF PRACTICE FOR POSITION & LAYOUT OF WATER CONNECTIONS TO APARTMENT BLOCKS TO BE CONFIRMED BY M&E CONTRACTOR DURING DESIGN STAGE.
  - APARTMENT BLOCK SUPPLY TO BE CONFIRMED BY M&E CONSULTANT.
  - PROPERTIES WILL BE INSTALLED INTERNALLY TO THE BUILDING CONTROL AUTHORITY'S REQUIREMENTS AND SUBJECT TO REVIEW BY IRISH WATER SEE SECTION 3.10.2 OF WATER CODE OF PRACTICE.
  - ISOLATION DEVICE TO BE INSTALLED ON WATER MAIN TO BE IN ACCORDANCE WITH SECTION 3.13 OF THE WATER CODE OF PRACTICE AND IS EN 1717.
  - WHERE FIREMANS ARE PROVIDED OF IRISH WATERS NETWORK A DEDICATED BULK FLOW METER SHALL BE PROVIDED AT THE DEVELOPERS COST. THE CONNECTION ARRANGEMENT SHALL BE PROVIDED WITH A NON-RETURN VALVE TO PREVENT BACKFLOW INTO THE WATER NETWORK S/D EN.

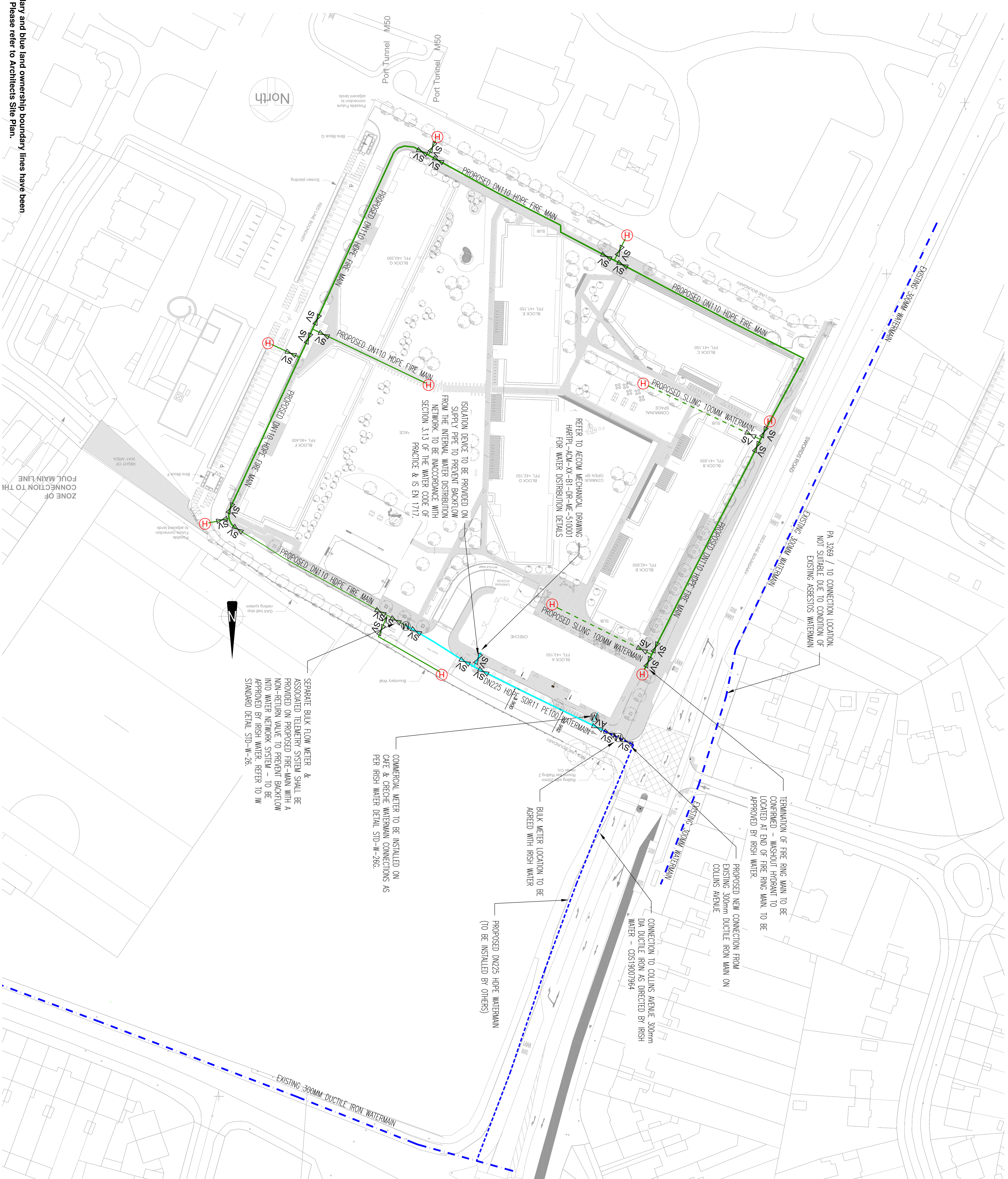

**Site Boundaries:**  
The red site boundary and blue land ownership boundary lines have been omitted for clarity. Please refer to Architects Site Plan.

- NOTES**
- EXISTING PUBLIC WATERMAIN
  - PROPOSED DN225 HOPE WATERMAIN
  - PROPOSED DN110 HOPE FIRE MAIN
  - PROPOSED SLUNG WATERMAIN
  - PROPOSED CONNECTION TO COLLINS AVENUE
  - EXISTING WATER MAIN AS DIRECTED BY IRISH WATER
- SV PROPOSED SLURGE VALVE
  - AV PROPOSED AIR VALVE
  - H PROPOSED FIRE HYDRANT
  - M BULK WATER METER

ISSUED FOR PLANNING

REV	DATE	DETAILS
C05	01/03/22	Revised as per M&E comments
C04	03/03/22	Issued for SHD Application
C03	11/03/21	Issued for SHD Application

**ior**  
Joseph O'Reilly  
Consulting Civil & Structural Engineers  
Unit 1, St. Theresa's Place, Fownhill, Navan, Co. Meath  
Tel: 046 9077032 Fax: 046 9077392  
Email: mh@ior.ie Web: www.ior.ie

<b>CLIENT</b> Eastwise Construction Swords Ltd	<b>TITLE</b> Site Services: Watermain Layout
<b>PROJECT</b> Hartfield Place, Whitehall, Swords Road, Whitehall, Dublin 9, D09 C7R8	<b>SCALE</b> 1:500 @ A0
	<b>DATE</b> Oct. 2021
	<b>ISSUED BY:</b> C05
	<b>CHECKED BY:</b> NS
	<b>DRAWING No.</b> HARTFL-JOR-SM-ZZ-DRC-C003
	<b>REV</b> C05